

CARTEC 80

CZ

OMEGA SHACKLE



Chain		Code	A	C	F	G	H	PxL	Weight	W.L.L.
mm	inch		mm	mm	mm	mm	mm	mm	Kg	Kg
7-8	9/32-5/16	CZ 08	8,7	24	32	11	18	9,5x33,5	0,18	2000
10	3/8	CZ 10	12,5	32	44	14	19	13x43,5	0,35	3150
13	1/2	CZ 13	15	40	55	17	25	17x57	0,72	5300
16	5/8	CZ 16	19	50	65	22	30	21x69	1,2	8000

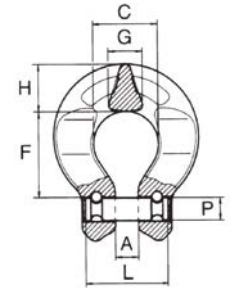

CZ

ANELLO A OMEGA



Catena		Codice	A	C	F	G	H	PxL	Peso	W.L.L.
mm	inch		mm	mm	mm	mm	mm	mm	Kg	Kg
7-8	9/32-5/16	CZ 08	8,7	24	32	11	18	9,5x33,5	0,18	2000
10	3/8	CZ 10	12,5	32	44	14	19	13x43,5	0,35	3150
13	1/2	CZ 13	15	40	55	17	25	17x57	0,72	5300
16	5/8	CZ 16	19	50	65	22	30	21x69	1,2	8000

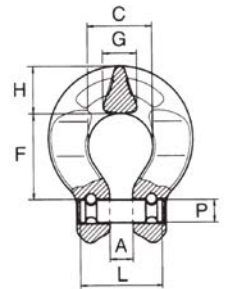

CZ

COUPLER OMEGA



Chaîne		Code	A	C	F	G	H	PxL	Poids	C.M.U.
mm	inch		mm	mm	mm	mm	mm	mm	Kg	Kg
7-8	9/32-5/16	CZ 08	8,7	24	32	11	18	9,5x33,5	0,18	2000
10	3/8	CZ 10	12,5	32	44	14	19	13x43,5	0,35	3150
13	1/2	CZ 13	15	40	55	17	25	17x57	0,72	5300
16	5/8	CZ 16	19	50	65	22	30	21x69	1,2	8000

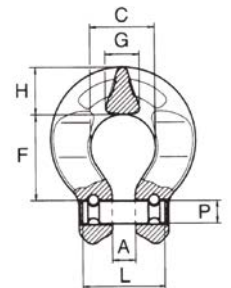

CZ

VERBINDUNGSBÜGEL OMEGA



Kette		Code	A	C	F	G	H	PxL	Gewicht	W.L.L.
mm	inch		mm	mm	mm	mm	mm	mm	Kg	Kg
7-8	9/32-5/16	CZ 08	8,7	24	32	11	18	9,5x33,5	0,18	2000
10	3/8	CZ 10	12,5	32	44	14	19	13x43,5	0,35	3150
13	1/2	CZ 13	15	40	55	17	25	17x57	0,72	5300
16	5/8	CZ 16	19	50	65	22	30	21x69	1,2	8000

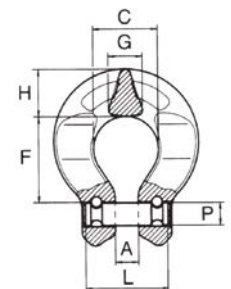

CARTEC 80

CZ

ANILLA OMEGA



Cadena		Código	A	C	F	G	H	PxL	Peso	W.L.L.
mm	inch		mm	mm	mm	mm	mm	mm	Kg	Kg
7-8	9/32-5/16	CZ 08	8,7	24	32	11	18	9,5x33,5	0,18	2000
10	3/8	CZ 10	12,5	32	44	14	19	13x43,5	0,35	3150
13	1/2	CZ 13	15	40	55	17	25	17x57	0,72	5300
16	5/8	CZ 16	19	50	65	22	30	21x69	1,2	8000

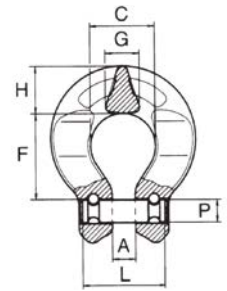

CZ

ELO DE LIGAÇÃO OMEGA



Cadeia		Código	A	C	F	G	H	PxL	Peso	W.L.L.
mm	inch		mm	mm	mm	mm	mm	mm	Kg	Kg
7-8	9/32-5/16	CZ 08	8,7	24	32	11	18	9,5x33,5	0,18	2000
10	3/8	CZ 10	12,5	32	44	14	19	13x43,5	0,35	3150
13	1/2	CZ 13	15	40	55	17	25	17x57	0,72	5300
16	5/8	CZ 16	19	50	65	22	30	21x69	1,2	8000

