

CARTEC 60

C6XCA

GR. 60 STAINLESS STEEL SLING HOOK WITH LATCH



| Chain | Code | A | B | D | G | H | O | R | S | Weight | W.L.L. |
|-----------------|-----------|----|-----|----|------|----|----|-----|----|--------|--------|
| mm inch | | mm | mm | mm | mm | mm | mm | mm | mm | Kg | Kg |
| 5-6 7/32 - 1/4 | C6XCA06SF | 23 | 72 | 8 | 13,5 | 21 | 21 | 90 | 8 | 0,31 | 900 |
| 7-8 9/32 - 5/16 | C6XCA08SF | 32 | 103 | 13 | 19,5 | 29 | 27 | 118 | 13 | 0,81 | 1600 |
| 10 3/8 | C6XCA10SF | 39 | 120 | 15 | 27 | 33 | 37 | 140 | 15 | 1,57 | 2500 |
| 13 1/2 | C6XCA13SF | 51 | 155 | 18 | 35 | 46 | 48 | 182 | 18 | 3,09 | 4250 |
| 16 5/8 | C6XCA16SF | 66 | 183 | 24 | 44 | 51 | 55 | 213 | 24 | 5,36 | 6300 |

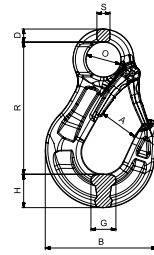

C6XCA

GANCIO AD OCCHIO IN ACCIAIO INOX GR.60



| Catena | Codice | A | B | D | G | H | O | R | S | Peso | W.L.L. |
|-----------------|-----------|----|-----|----|------|----|----|-----|----|------|--------|
| mm inch | | mm | mm | mm | mm | mm | mm | mm | mm | Kg | Kg |
| 5-6 7/32 - 1/4 | C6XCA06SF | 23 | 72 | 8 | 13,5 | 21 | 21 | 90 | 8 | 0,31 | 900 |
| 7-8 9/32 - 5/16 | C6XCA08SF | 32 | 103 | 13 | 19,5 | 29 | 27 | 118 | 13 | 0,81 | 1600 |
| 10 3/8 | C6XCA10SF | 39 | 120 | 15 | 27 | 33 | 37 | 140 | 15 | 1,57 | 2500 |
| 13 1/2 | C6XCA13SF | 51 | 155 | 18 | 35 | 46 | 48 | 182 | 18 | 3,09 | 4250 |
| 16 5/8 | C6XCA16SF | 66 | 183 | 24 | 44 | 51 | 55 | 213 | 24 | 5,36 | 6300 |

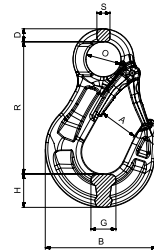

C6XCA

CROCHET À ŒIL AVEC LINGUET EN ACIER INOX GR. 60



| Chaîne | Code | A | B | D | G | H | O | R | S | Poids | C.M.U. |
|-----------------|-----------|----|-----|----|------|----|----|-----|----|-------|--------|
| mm inch | | mm | mm | mm | mm | mm | mm | mm | mm | Kg | Kg |
| 5-6 7/32 - 1/4 | C6XCA06SF | 23 | 72 | 8 | 13,5 | 21 | 21 | 90 | 8 | 0,31 | 900 |
| 7-8 9/32 - 5/16 | C6XCA08SF | 32 | 103 | 13 | 19,5 | 29 | 27 | 118 | 13 | 0,81 | 1600 |
| 10 3/8 | C6XCA10SF | 39 | 120 | 15 | 27 | 33 | 37 | 140 | 15 | 1,57 | 2500 |
| 13 1/2 | C6XCA13SF | 51 | 155 | 18 | 35 | 46 | 48 | 182 | 18 | 3,09 | 4250 |
| 16 5/8 | C6XCA16SF | 66 | 183 | 24 | 44 | 51 | 55 | 213 | 24 | 5,36 | 6300 |

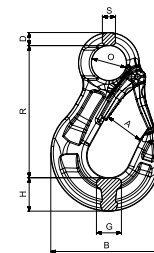

C6XCA

ÖSENLASTHAKEN MIT SICHERUNG AUS ROSTFREIEM STAHL GK 6



| Kette | Code | A | B | D | G | H | O | R | S | Gewicht | W.L.L. |
|-----------------|-----------|----|-----|----|------|----|----|-----|----|---------|--------|
| mm inch | | mm | mm | mm | mm | mm | mm | mm | mm | Kg | Kg |
| 5-6 7/32 - 1/4 | C6XCA06SF | 23 | 72 | 8 | 13,5 | 21 | 21 | 90 | 8 | 0,31 | 900 |
| 7-8 9/32 - 5/16 | C6XCA08SF | 32 | 103 | 13 | 19,5 | 29 | 27 | 118 | 13 | 0,81 | 1600 |
| 10 3/8 | C6XCA10SF | 39 | 120 | 15 | 27 | 33 | 37 | 140 | 15 | 1,57 | 2500 |
| 13 1/2 | C6XCA13SF | 51 | 155 | 18 | 35 | 46 | 48 | 182 | 18 | 3,09 | 4250 |
| 16 5/8 | C6XCA16SF | 66 | 183 | 24 | 44 | 51 | 55 | 213 | 24 | 5,36 | 6300 |

